

**GPC-400TB - OMNI ANTENNA BASE UHF
380-520 MHz**

Type	Colineal 5/8
Power	250W
Gain	5,5 dBd (7,65 dBi)
Impedance	50 ohm
Material	Aluminum
R.O.E - S.W.R - T.O.S	1,2:1
Type mounting	Mast 0,030-0,045 m
Connector type	Connector N female
Radiator length	0,73 m
Polarization	Vertical
Temperature (°C)	from -40° to 55°
Adjust type	Adjustabled
Support	Included
Radial length	0,16 m
Length	0,74 m
Weight	1,10 kg

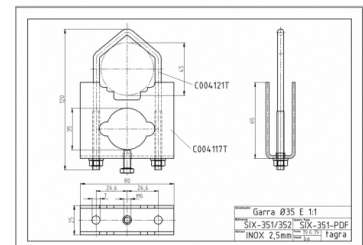

All specifications are subject to change without notice.

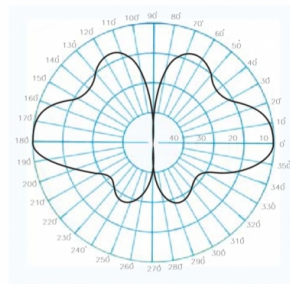
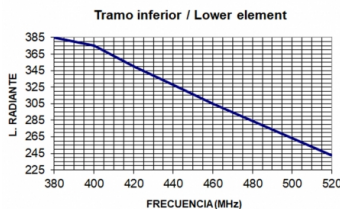
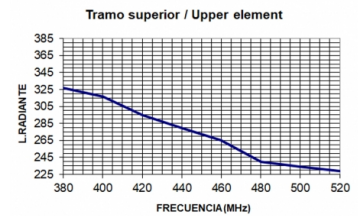