

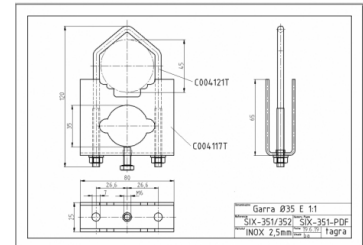

GP-400-5/8 - OMNI GSM ANTENNA 380-490 MHz

Type	Ground plane 5/8
Power	125 W
Gain	3 dBd (5,15 dBi)
Impedance	50 ohm
Material	Aluminum
R.O.E - S.W.R - T.O.S	1,3:1
Type mounting	Mast 0,030-0,045 m
Connector type	Female N connector
Radiator length	0,43 m
Polarization	Vertical
Adjust type	Adjusted
Support	Included
Radial length	0,16 m
Length	0,43 m
Weight	0,75 kg
Package dimensions	0,6 x 0,1 x 0,1 m

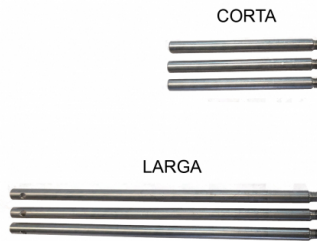

NO INCLUIDO



OPCIONAL

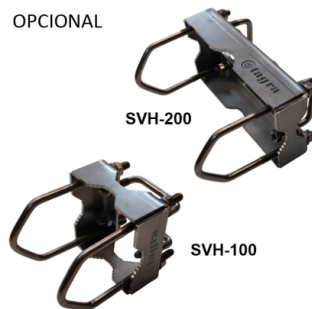

	TUBE Ø 16	ROD
380 MHz	540 mm	short
400 MHz	540 mm	long
433 MHz	540 mm	short
460 MHz	445 mm	short
490 MHz	370 mm	short

All specifications are subject to change without notice.

