



**DVC-6AN - YAGI ANTENNA 6 ELEMENTS VHF NH
136-146 MHz**

| | |
|-----------------------|--|
| Elements | 6 |
| Power | 500W |
| Gain | 10 dBd (12,15 dBi) |
| Impedance | 50 ohm |
| Material | Anodized aluminium QUALANOD certificate |
| R.O.E - S.W.R - T.O.S | 1,5:1 |
| Connector type | N (FEMALE) |
| Radiator lenght | 2 m. |
| Electrical protection | Yes |
| Polarization | Vertical & Horizontal |
| Wind load | 180 km/h |
| Temperature (°C) | from -10° to 50° |
| Adjust type | Dipolo Gamma match |
| Rel. front/back | 16 dB |
| Mastil diameter | 0,030-0,045 m |
| Support | Included |
| Element lenght | 0,96 m |
| Length | 2,00 m |
| Weight | 2,60 kg |
| Package dimensions | 2,2 x 0,1 x 0,1 m |



Support and connector view



CON SISTEMA DE CORTOCIRCUITO
WITH SHORT CIRCUIT SYSTEM
AVEC SYSTÈME DE COURT-CIRCUIT

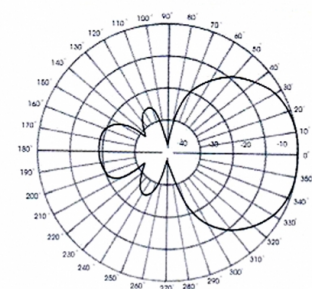

Vertical radiation pattern

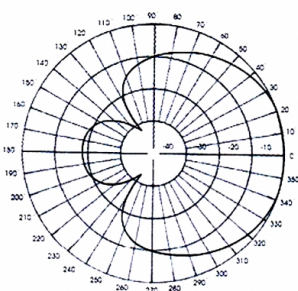

Horizontal radiation pattern

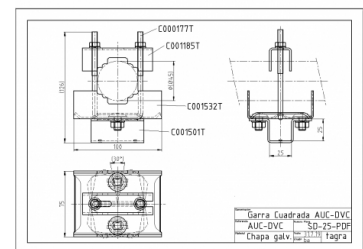

All specifications are subject to change without notice.

